

Quetschkabelschuhe nach DIN 46 234

Werkstoff: E-Cu, Oberfläche: galvanisch verzinkt

Ringform

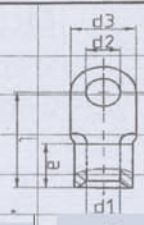

Querschnitt mm ²	Anschluss	Type	d1 mm	d2 mm	d3 mm	l mm	a mm	VPE
35	M 6	B 6 - 35 R	9,0	6,5	15,0	26,0	12,0	50
	M 8	B 8 - 35 R		8,4	16,0	26,0		50
	M 10	B 10 - 35 R		10,5	18,0	27,0		50
	M 12	B 12 - 35 R		13,0	22,0	31,0		50
	M 16	B 16 - 35 R		17,0	28,0	36,0		50
	M 20	B 20 - 35 R		21,0	30,0	37,5		50
50	M 6	B 6 - 50 R	11,0	6,5	18,0	34,0	16,0	50
	M 8	B 8 - 50 R		8,4	18,0	34,0		50
	M 10	B 10 - 50 R		10,5	18,0	34,0		50
	M 12	B 12 - 50 R		13,0	22,0	36,0		50
	M 16	B 16 - 50 R		17,0	28,0	40,0		50
	M 20	B 20 - 50 R		21,0	32,0	41,2		50
70	M 6	B 6 - 70 R	13,0	6,5	22,0	38,0	18,0	50
	M 8	B 8 - 70 R		8,4	22,0	38,0		50
	M 10	B 10 - 70 R		10,5	22,0	38,0		50
	M 12	B 12 - 70 R		13,0	22,0	38,0		50
	M 16	B 16 - 70 R		17,0	28,0	42,0		50
	M 20	B 20 - 70 R		21,0	32,0	45,0		50
95	M 8	B 8 - 95 R	15,0	8,4	24,0	42,0	20,0	25
	M 10	B 10 - 95 R		10,5	24,0	42,0		25
	M 12	B 12 - 95 R		13,0	24,0	42,0		25
	M 16	B 16 - 95 R		17,0	28,0	44,0		25
	M 20	B 20 - 95 R		21,0	32,0	51,8		25
120	M 8	B 8 - 120 R	16,5	8,4	24,0	44,0	22,0	25
	M 10	B 10 - 120 R		10,5	24,0	44,0		25
	M 12	B 12 - 120 R		13,0	24,0	44,0		25
	M 16	B 16 - 120 R		17,0	28,0	48,0		25
	M 20	B 20 - 120 R		21,0	32,0	53,0		25
150	M 10	B 10 - 150 R	19,0	10,5	30,0	50,0	24,0	25
	M 12	B 12 - 150 R		13,0	30,0	50,0		25
	M 16	B 16 - 150 R		17,0	30,0	50,0		25
	M 20	B 20 - 150 R		21,0	36,0	63,0		27,0
185	M 10	B 10 - 185 R	21,0	10,5	36,0	50,0	28,0	25
	M 12	B 12 - 185 R		13,0	36,0	50,0		25
	M 16	B 16 - 185 R		17,0	36,0	50,0		25
240	M 10	B 10 - 240 R	23,5	10,5	38,0	56,0	32,0	25
	M 12	B 12 - 240 R		13,0	38,0	56,0		25
	M 16	B 16 - 240 R		17,0	38,0	56,0		25

