

Rohrkabelschuhe, 90° abgewinkelt, EURO-SERIE

(=kompatibel zu vielen anderen Fabrikaten), Ringform

Werkstoff: E-Cu Rohr nach DIN 40 500 Oberfläche: galvanisch verzinkt

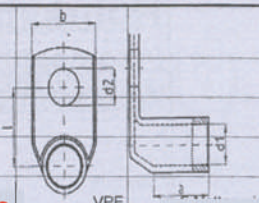

Querschnitt mm ²	Anschluss	Type	d1 mm	d2 mm	d3 mm	l mm	a mm	VPE
150	M 10	KRWE 150-10/90°	16,5	10,5	32,0	26,0	30,0	25
	M 12	KRWE 150-12/90°		13,0	32,0	27,0		25
	M 16	KRWE 150-16/90°		17,0	32,0	30,0		25
185	M 10	KRWE 185-10/90°	18,5	10,5	35,0	27,0	32,0	25
	M 12	KRWE 185-12/90°		13,0	35,0	28,0		25
	M 16	KRWE 185-16/90°		17,0	35,0	31,0		25
	M 20	KRWE 185-20/90°		21,0	35,0	35,0		25
240	M 12	KRWE 240-12/90°	21,0	13,0	40,0	29,0	37,0	25
	M 16	KRWE 240-16/90°		17,0	40,0	32,0		25
	M 20	KRWE 240-20/90°		21,0	40,0	36,0		25

Rohrkabelschuhe, 45° abgewinkelt, EURO-SERIE

(=kompatibel zu vielen anderen Fabrikaten), Ringform

Werkstoff: E-Cu Rohr nach DIN 40 500 Oberfläche: galvanisch verzinkt

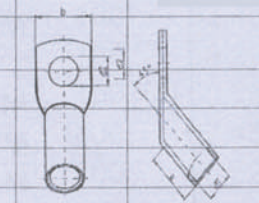

Querschnitt mm ²	Anschluss	Type	d1 mm	d2 mm	b mm	a mm	VPE
10	M 5	KRWE 10- 5/45°	4,3	5,3	12,0	9,0	100
	M 6	KRWE 10- 6/45°		6,4	12,0		100
	M 8	KRWE 10- 8/45°		8,4	15,0		100
16	M 6	KRWE 16- 6/45°	5,5	6,4	12,0	12,0	100
	M 8	KRWE 16- 8/45°		8,4	15,0		100
	M 10	KRWE 16-10/45°		10,5	18,0		100
25	M 6	KRWE 25- 6/45°	6,9	6,4	15,0	14,0	100
	M 8	KRWE 25- 8/45°		8,4	16,0		100
	M 10	KRWE 25-10/45°		10,5	18,0		100
	M 12	KRWE 25-12/45°		13,0	20,0		100
35	M 6	KRWE 35- 6/45°	8,5	6,4	17,0	16,0	50
	M 8	KRWE 35- 8/45°		8,4	17,0		50
	M 10	KRWE 35-10/45°		10,5	20,0		50
	M 12	KRWE 35-12/45°		13,0	22,0		50
50	M 8	KRWE 50- 8/45°	10,0	8,4	20,0	18,0	50
	M 10	KRWE 50-10/45°		10,5	20,0		50
	M 12	KRWE 50-12/45°		13,0	23,0		50

